

REV	REVISION RECORD
A	

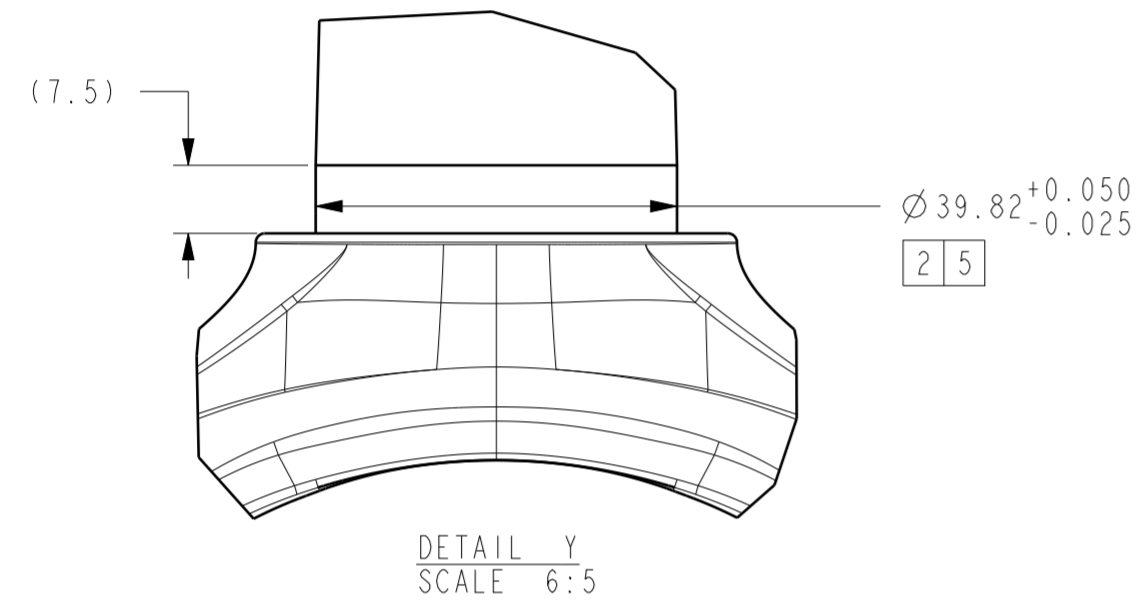
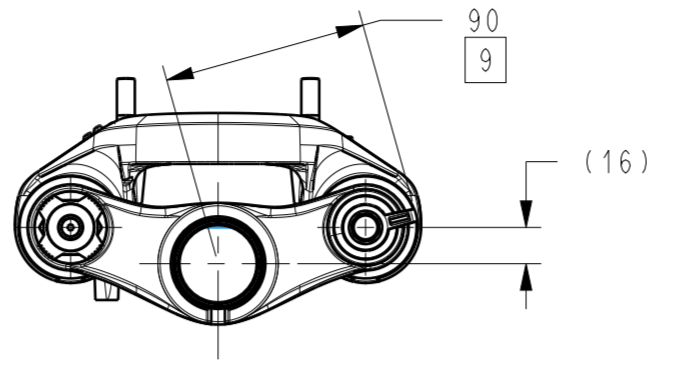
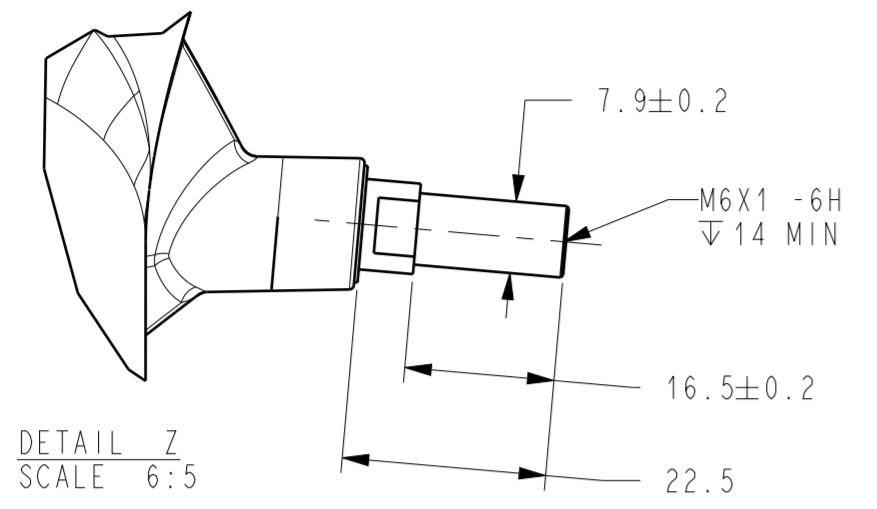

-STEER TUBE DETAILS-		
STEER TUBE TYPE	Ø A mm	Ø B mm
ALUMINUM, THREADLESS	Ø 38.14±0.05	(Ø 35.1)

NOTES: (UNLESS OTHERWISE SPECIFIED)

- DRAWING NOT TO SCALE, GENERAL SHAPE FOR DIMENSIONAL REFERENCE ONLY. SRAM RESERVES THE RIGHT TO CHANGE SPECIFICATIONS WITHOUT PRIOR NOTICE.
- CROWN RACE TO BE MEASURED AS AVERAGE Ø; 3 DIAMETRIC POINTS MIN.
- REFERENCE DIMENSIONS, NOTED WITH PARENTHESIS "( )" ARE FOR CUSTOMER DESIGN INFORMATION ONLY.
- DIMENSION IS PERPENDICULAR OFFSET FROM STEERER TUBE AXIS TO DROP OUT CENTER (FORK OFFSET DIMENSION).
- HEADSET CUP INSIDE DIAMETER MUST NOT BE LESS THAN STEERER TUBE DIAMETER + 0.3MM.
- IMPORTANT: CUSTOMER IS RESPONSIBLE FOR ENSURING MINIMUM REQUIRED TIRE CLEARANCE PER ASTM F 08.10-02S, SEE SECTION 6.1.1.2. (17JAN03 DRAFT)
- POST TYPE BRAKE CALIPER MOUNT, DIRECT FOR 160MM ROTOR DIA. MAX ROTOR DIA = 215MM.
- 3D REPRESENTATION FILES (IGS & STP) AVAILABLE UPON REQUEST.
- FORK / FRAME CLEARANCE (WORST CASE)
- MAXIMUM RECOMMENDED BRAKE CALIPER BOLT TORQUE=10.2N·M (90IN·LB).
- CROWN RACE TO AXLE DISTANCE SHOWN BASED ON MEDIUM SPRING, MIN PRELOAD.

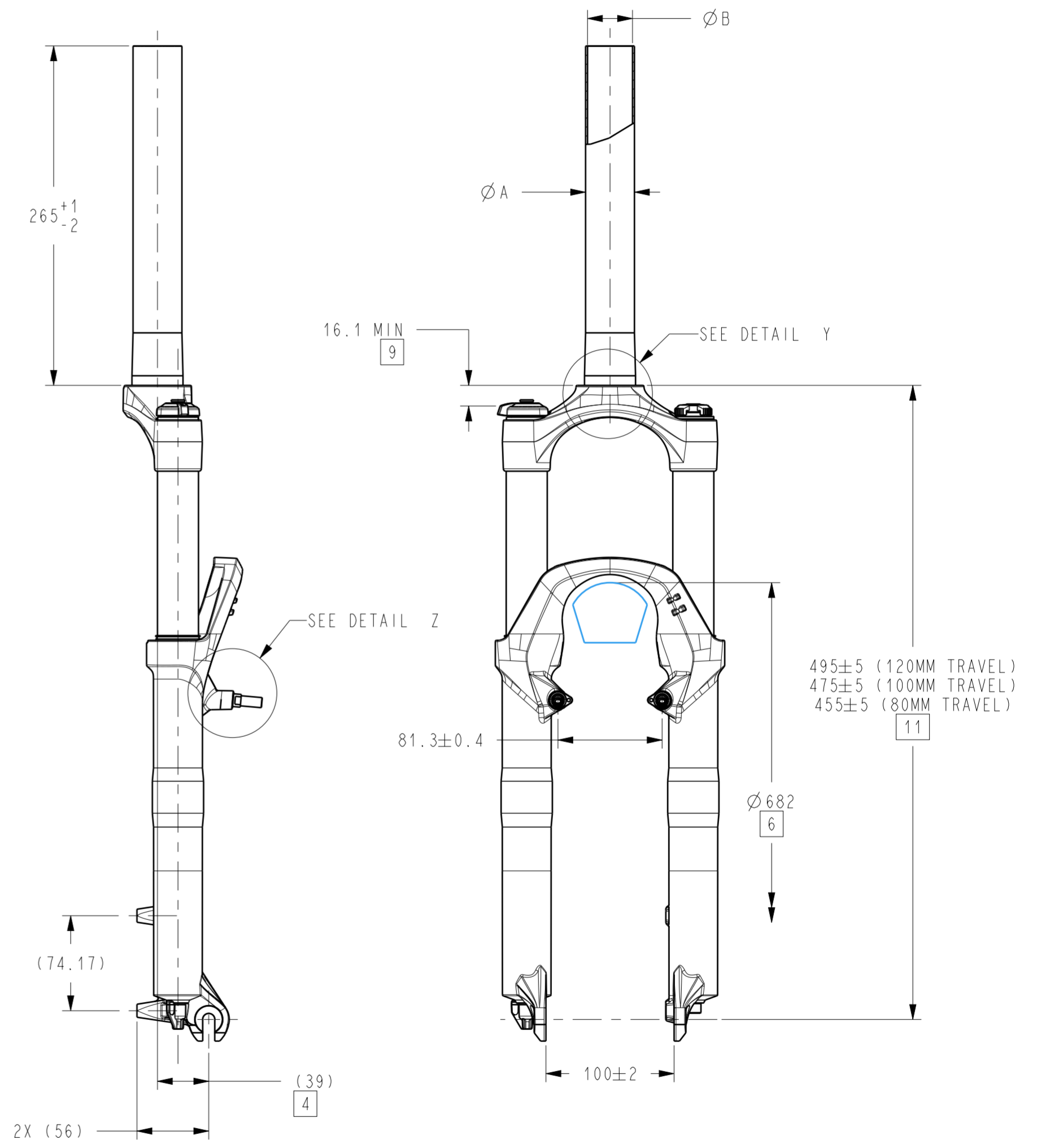
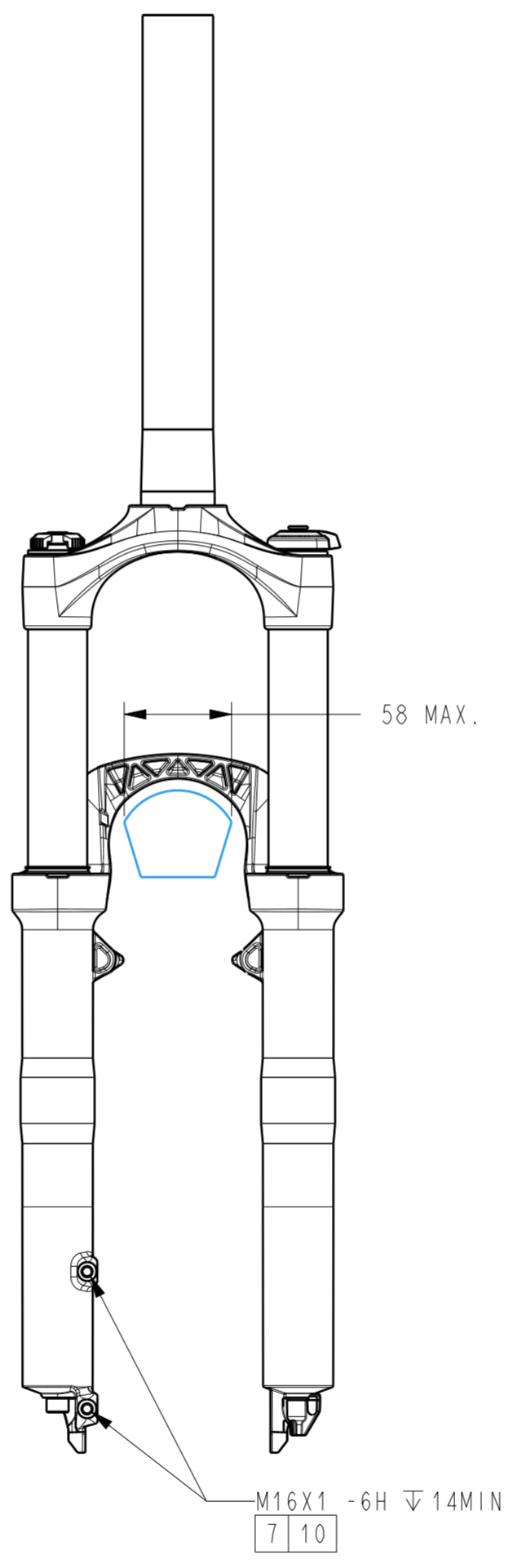

ALL DIMENSIONS ARE mm	GEOMETRIC DIMENSIONING AND TOLERANCING TO BE INTERPRETED PER ANSI Y14.5M 1994.
THIRD ANGLE PROJECTION	• INDICATES THE DIMENSION IS CRITICAL TO THE FORM, FIT OR FUNCTION OF THE PART OR PRODUCT
MASS (g)	UNTOLERANCED LENGTH DIMENSIONS (mm)
MATERIAL	LENGTH DIMENSIONS TOLERANCE
	from 0.5 up to 6 ± 0.1
	over 6 up to 30 ± 0.2
	over 30 up to 120 ± 0.3
	over 120 up to 400 ± 0.5
	UNTOLERANCED ANGLE DIMENSIONS ± 5°

DESIGNED BY: NJ CHEN	FORMAT: A2	SCALE: 3:10	SHEET: 1 / 1
LIFECYCLE STATUS	 CONFIDENTIAL - THIS DRAWING CONTAINS INFORMATION THAT IS PROPRIETARY TO SRAM CORPORATION AND MAY NOT BE DISCLOSED WITHOUT PERMISSION.		
In Work	DRAWING NAME / DESCRIPTION		
	USER SPEC. ROCKSHOX. XC32.TK 1.5		
	DRAWING NUMBER	VERSION	
	98-4015-023-020	A.1	